

SECTION II

TM 9-2330-267-14&P

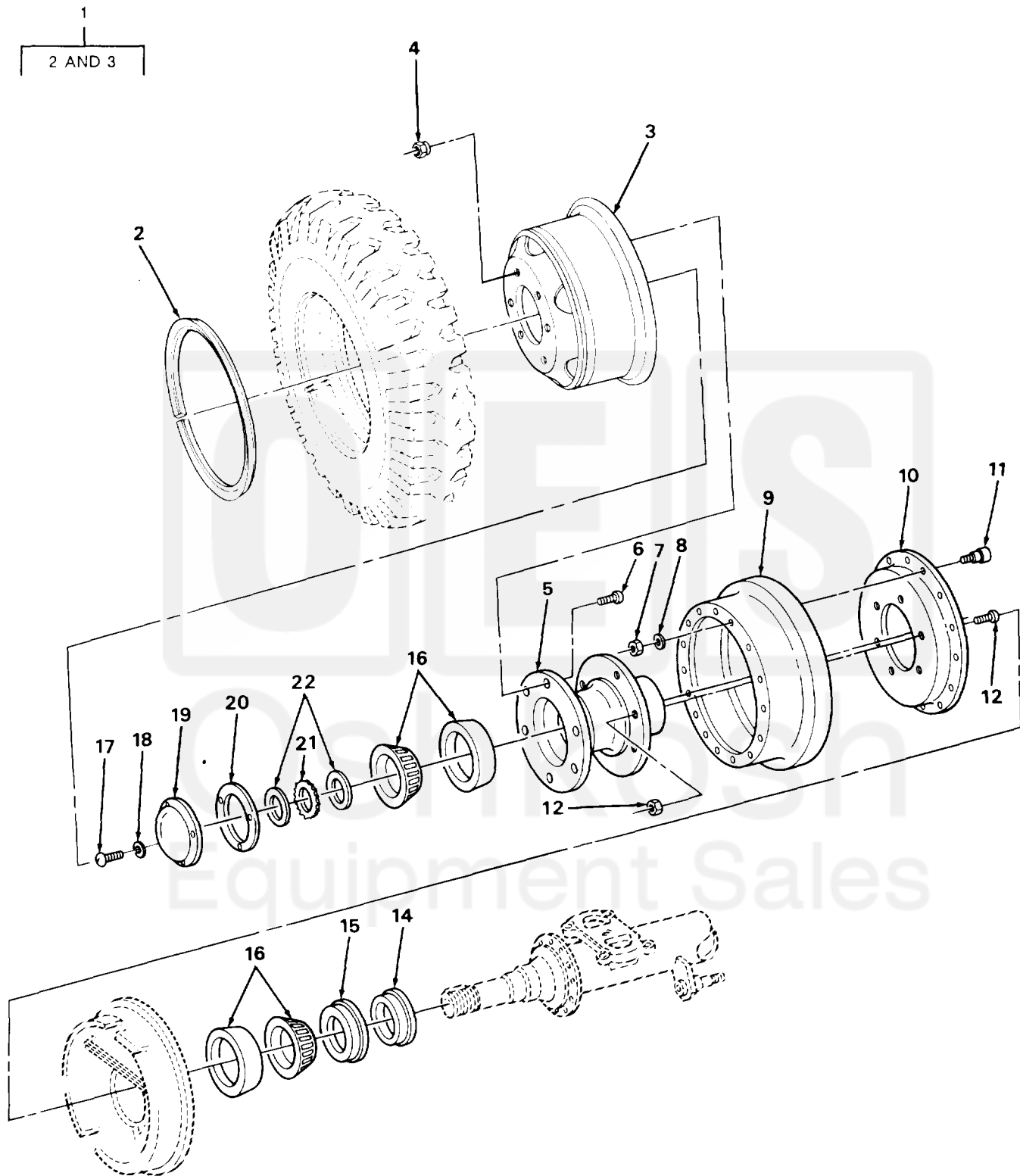

TA506239

FIGURE 17. WHEEL ASSEMBLY AND HUB COMPONENTS.

SECTION II (1)	ITEM (2)	SMR (3)	TM9-2330-267-14&P (4)	(5)	(6)
NO	CODE	CAGEC	PART NUMBER	DESCRIPTION AND USABLE ON CODES (UOC)	QTY
GROUP 13 WHEELS					
GROUP 1311 WHEEL ASSEMBLY					
FIG. 17 WHEEL ASSEMBLY AND HUB COMPONENTS					
1	A0000	96906	MS53044-5	WHEEL,PNEUMATIC TIR UOC:292,997	2
2	PAOZZ	19207	7389061	.RING,SIDE,AUTOMOTIV WHEEL	1
3	XAOZZ	19207	7389620	.WHEEL,PNEUMATIC TIR	1
4	PAOZZ	96906	MS51983-1	NUT,PLAIN,SINGLE BA LEFT HAND	6
4	PAOZZ	96906	MS51983-2	NUT,PLAIN,SINGLE BA RIGHT HAND	6
5	PAFZZ	19207	8719915	HUB	2
6	PAOZZ	96906	MS51946-1	BOLT,RIBBED SHOULDE LEFT HAND	6
6	PAOZZ	96906	MS51946-2	BOLT,RIBBED SHOULDE RIGHT HAND	6
7	PAFZZ	96906	MS21045-6	NUT,SELF-LOCKING,HE	36
8	PAFZZ	96906	MS27183-14	WASHER,FLAT	36
9	PAFZZ	19207	7411425	BRAKE DRUM	2
10	PAFZZ	19207	7413231	PLATE,BACKING,BRAKE	2
11	PAFZZ	18876	8720025	BOLT,RIBBED NECK	36
12	PAFZZ	19207	8333780	BOLT,RIBBED SHOULDE	12
13	PAFZZ	96906	MS35692-61	NUT,PLAIN,SLOTTED,H	12
14	PAOZZ	19207	7411433	SPACER,SLEEVE	2
15	PAOZZ	19207	7411429	SEAL,PLAIN ENCASED	2
16	PAOZZ	08162	3984	BEARING,ROLLER,TAPE	4
17	PAOZZ	96906	MS35206-279	SCREW,MACHINE	6
18	PAOZZ	96906	MS35338-63	WASHER,LOCK	6
19	PAOZZ	19200	6144454	HUB CAP,WHEEL	2
20	PAOZZ	78500	6144356	GASKET	1
21	PAOZZ	19207	7411378	WASHER,KEY	2
22	PAOZZ	19207	7411379	NUT,PLAIN,OCTAGON	4

END OF FIGURE

